

HW-G series

INSTRUCTION MANUAL

Digital Platform Scale

HW-10KGL

HW-10KGV

HW-60KGL

HW-60KGV

HW-100KGL

HW-100KGV

HW-200KGL

HW-200KGV

A&D
A&D MERCURY PTY. LTD.



This is a hazard alert mark.



This mark informs you about the operation of the product.

Note This manual is subject to change without notice at any time to improve the product. No part of this manual may be photocopied, reproduced, or translated into another language without the prior written consent of A&D Mercury Pty. Ltd..

Product specifications are subject to change without any obligation on the part of the manufacturer.



1	Compliance	3
1.1	Compliance with FCC rules	3
2	Outline and Features	4
3	Unpacking	5
3.1	Accessories and Options list	6
4	Caution	8
4.1	Precautions for Installing the Scale	8
4.2	Precautions for Operating the Scale	8
4.3	Precautions for Storing the Scale	8
5	Installing the Scale	9
5.1	Installing the batteries for Type L	11
6	Names	12
6.1	Display and Symbols	13
6.2	Switches	15
7	Basic Operation	17
7.1	Turning the Scale on/off and Weighing	17
7.1.1	Type V or Type L with AC adaptor	17
7.1.2	Type L with Batteries	18
7.2	Tare (and Net Display)	19
7.2.1	Semi-Automatic Tare (Input by Weighing)	19
7.2.2	Preset Tare (Digital Input of Known Tare)	19
7.3	Mode Switch (Changing Unit and Mode)	20
8	Counting Mode	21
8.1	Storing a Unit Mass	21
8.2	Counting the number of articles	22
9	Percentage Mode	23
9.1	Storing a 100% Mass	23
9.2	Reading Percentage	24
10	Accumulation Function	25
10.1	Preparation (Setting Parameters)	26
10.2	Operation and Performance (Examples)	27
11	Comparator Function	28
11.1	Preparation (Setting Parameters)	29
11.2	Operation and Performance (Examples)	31
12.	Full/Dribble Batch Function	32
12.1	Preparation (Setting Parameters)	34
13.	Simple Batch Function	36
13.1	Preparation (Setting Parameters)	37
13.2	Operation and Performance (Examples)	38

14	Calibration (Adjusting the Scale).....	39
14.1	The Gravity Acceleration Table	40
14.2	The Complete Calibration Procedure	41
14.2.1	Gravity Acceleration Correction	41
14.2.2	Preparation	41
14.2.3	Calibration of the Zero Point	42
14.2.4	Span Calibration	42
15	The Function Table	43
15.1	The Procedure for Setting Parameters	43
15.2	Parameter List	44
16	RS-232C Serial Interface	48
16.1	Data Format	49
16.2	Stream Mode	51
16.2.1	Preparation and Performance (Examples)	51
16.3	Command mode	52
16.3.1	Command List	52
16.4	Preparation (Setting Parameters)	55
17	Options	56
17.1	RS-232C/ Relay output/ Buzzer (OP-03)	56
17.2	RS-422/ RS-485 / Relay output (OP-04)	57
17.2.1	Communication Format	59
17.2.2	Command List	59
17.3	Internal Printer for Type V (OP-06)	62
18	Specifications	65
19	Maintenance	68
19.1	Repair	68
19.2	Check points Before Calling Maintenance	68



1 Compliance



1.1 Compliance with FCC rules

Please note that this equipment generates, uses and can radiate radio frequency energy. This equipment has been tested and has been found to comply with the limits of a Class A computing device pursuant to Sub-part J of Part 15 of FCC rules. These rules are designed to provide reasonable protection against interference when this equipment is operated in a commercial environment. If this unit is operated in a residential area it might cause some interference and under these circumstances the user would be required to take, at his own expense, whatever measures are necessary to eliminate the interference.

(FCC = Federal Communications Commission in the U.S.A.)



2 Outline and Features

The HW-G series is a platform scale with a minimum resolution of 1/10000 .

Type L scales have an LCD (Liquid Crystal Display) and use batteries as a power source to provide portability. This type can also use an AC mains adaptor.

Type V scales have a fluorescent display so the weighing value can be read in dim light. This type uses the AC power line as a power source.

The base unit (platform) is water-resistant in accordance with IP-65 specifications.

The counting mode function converts the total mass value (total weight) of articles to a count, assuming all items to have the same mass.

The percentage mode function displays the mass of an item as a percentage of a stored 100% mass.

The accumulation function accumulates each weighing value and counts the number of weighings.

The comparator function compares the display value with the upper limit value (HI) and the lower limit value (LO) and displays the result. The result can output if option OP-03 is installed.

The simple batch function or full/dribble batch function can be used for filling to a target mass value. The status of a weighing value can be output if option OP-03 or OP-04 is installed. The outputs are Zero Band, Preliminary and Final.

The optional RS-422/RS-485 serial interface can control up to 16 scales from a computer when this option is installed in place of the standard RS-232C serial interface.

Type V scales can be equipped with option OP-06, a built-in impact dot matrix printer.



3 Unpacking

Products
HW-10KGL
HW-10KGV

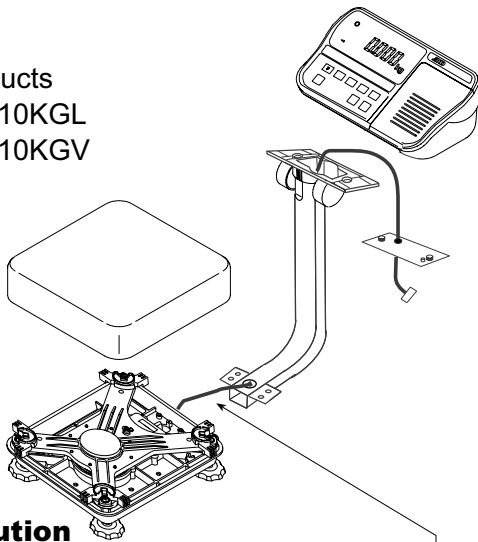

Caution
Do not pull the load-cell cable.

Products
HW-60KGL HW-60KGV

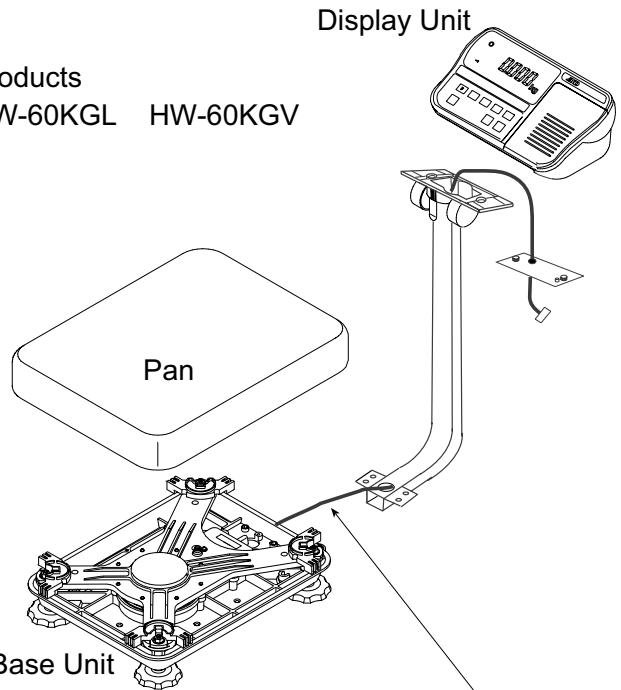

Caution
Do not pull the load-cell cable.

Products
HW-100KGL HW-100KGV
HW-200KGL HW-200KGV

Display Unit

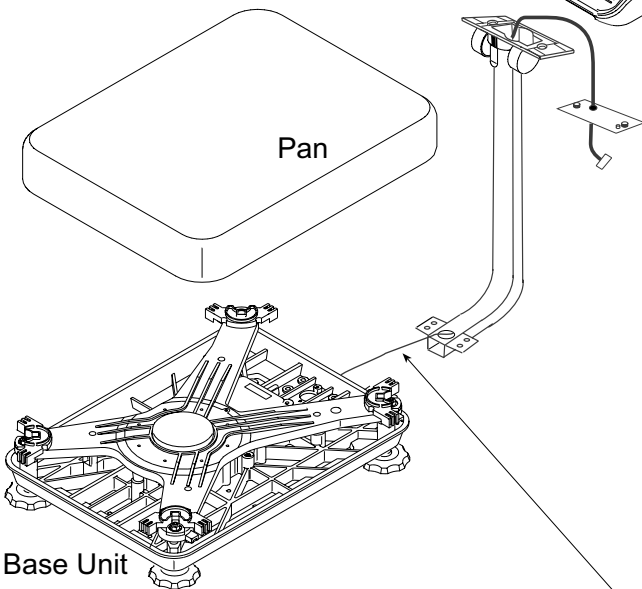

Caution
Do not pull the load-cell cable.

All Accessories

Refer to the accessories on page 6. The combination of accessories depends upon the model.

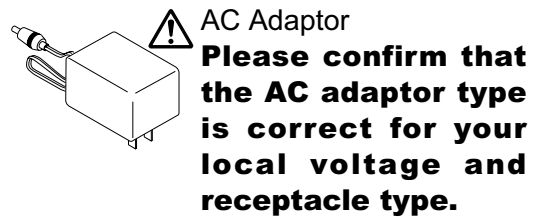

AC Adaptor
Please confirm that the AC adaptor type is correct for your local voltage and receptacle type.

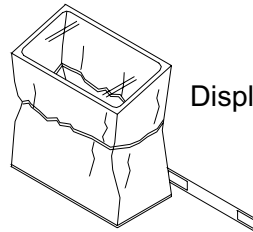

Display unit cover



5mm allen wrench

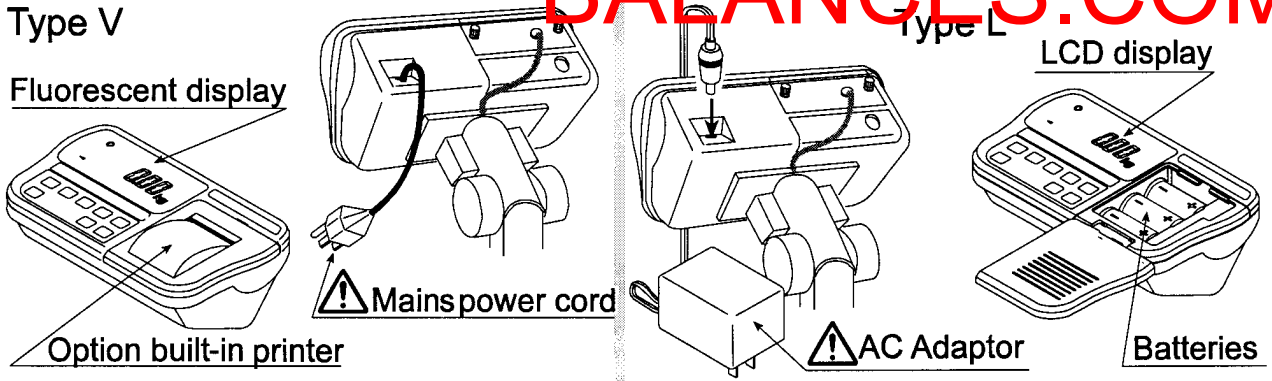

Please confirm that the mains power type or AC adaptor type is correct for your local voltage and receptacle type.



3.1 Accessories and Options list

Accessories for HW-G series

Type	Products	Accessories
Type V	HW-10KGV	Display unit cover Instruction manual
	HW-60KGV HW-100KGV HW-200KGV	Display unit cover 5mm Allen wrench Instruction manual
Type L	HW-10KGL	Display unit cover AC adaptor Instruction manual
	HW-60KGL HW-100KGL HW-200KGL	Display unit cover 5mm Allen wrench AC adaptor Instruction manual

Order code or option name	Accessories
OP-03 RS232C interface / Relay output / Buzzer	Connector JA:TCP0586
OP-04 RS422/485 interface / Relay output	Connector TM:BLA9 AC adaptor
OP-06 Built-in printer for type V	Paper PP156 Ink ribbon ERC-05
AX-K0557A RS232C cable, D-sub 25 pin, 2m	
AX-KO1786-200 RS232C cable, D-sub 9 pin, 2m	

Consumables

AX-PP156-S Special roll paper (10 rolls in a set)
AX-ERC-05-S Ink ribbon (5 ribbons in a set)

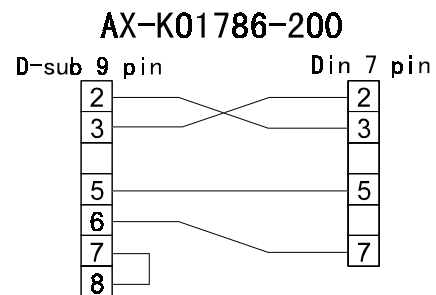
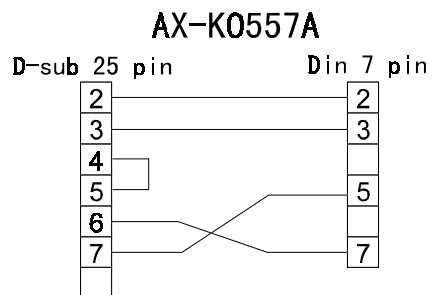



4 Caution



4.1 Precautions for Installing the Scale

Consider the following conditions to get the most from your scale.

The best operation is where the temperature and relative humidity are stable, the scale is installed on a solid floor or bench and there is no draft.

Do not install the scale in direct sunlight.

Do not install the scale near heaters or air conditioners.

Do not install the scale where there is flammable or corrosive gas present.

Do not install the scale near equipment which produces magnetic fields.

Do not install the scale where there is likely to be static electricity discharges in a place where the relative humidity is lower than 45%RH. Plastic and isolators are likely to be charged with static electricity.

The display unit is **not water resistant**. Use the display unit cover to avoid damage.

Do not use an unstable power source.



4.2 Precautions for Operating the Scale

Periodically check the scale with a known weight.

Calibrate the scale before using it and after moving it to another location.

Do not place anything on the pan which is heavier than the weighing capacity

Do not drop anything onto the pan.

Do not use a sharp instrument such as a pencil or ball-point pen to press the switches. Press the switches gently using only your finger.

We recommend pressing the **ZERO** or **TARE** switch before each weighing to prevent possible error.

Replace used dry cells with six new ones when the **BATT** symbol is displayed. Dry cell (battery) is size D.



4.3 Precautions for Storing the Scale

Do not disassemble the scale.

Do not use solvents to clean the scale.

For best cleaning of the display unit, wipe with a dry lint free cloth or a lint free cloth which is moistened with warm water and a mild detergent.

The base unit can be cleaned with gentle water jets while brushing the base unit.

Weigh only after the unit is dry.

Protect the display unit from dust and water by using the vinyl cover.

Remove batteries from display unit when the scale is not in use for a long time. If you leave the batteries installed they may leak and damage the scale.



5 Installing the Scale

This procedure includes all of the steps for installing the HW-G series scales

Step 1 Unpacking

Remove the weighing pan from the carton and place to one side. Remove the base unit and column from the carton, taking care not to pull on the loadcell cable.

Step 2 Secure the Column

Step 2a Remove the 4 Allen screws from the column lower bracket.

Step 2b Pull the excess loadcell cable through the column as you position the column to the base unit, so as not to damage the loadcell cable. Affix the column to the base unit using four 5mm Allen screws.

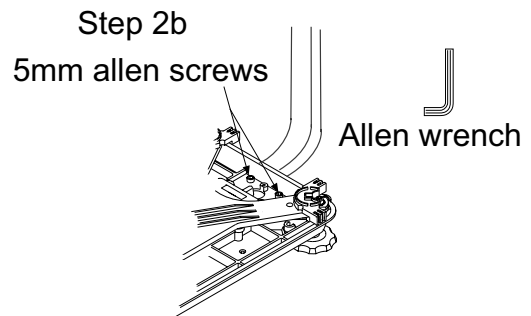
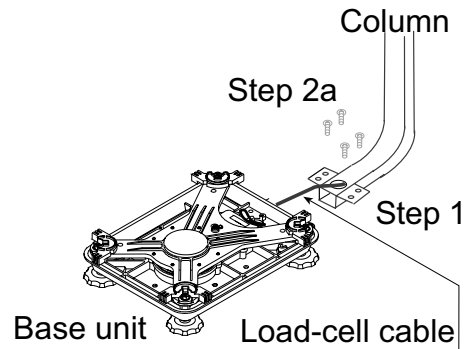

Step 3 Secure the Display Unit

Step 3a Remove the 2 screws from the rear of the display unit, position the display unit onto the column bracket and pull the excess cable back down the centre of the column to the base unit. Ensure that the cable exits via the cut out in the display unit column bracket and secure the headwork with the 2 screws.

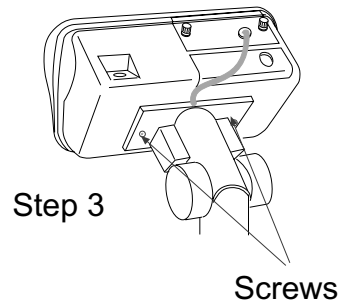

Step 3b Carefully make the connection between the cable connector and J1 inside the headwork, then secure the rear display panel.

Step 4 Fit the Pan

Step 4 Fold the excess cable at the basework end and secure with the 'twist and tie' strip provided.

Fit the pan to the base unit.

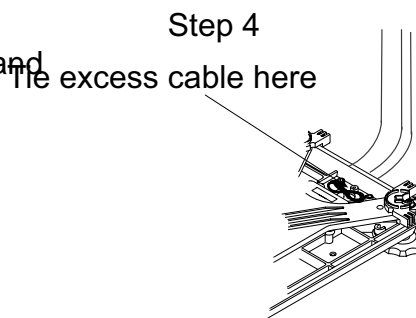

Select the place where you intend to instal the scale.
Consider “4. Caution” on page 8.

Step 5 Level the Scale

Level the base unit by using the “Bubble spirit level” and “Levelling feet”.

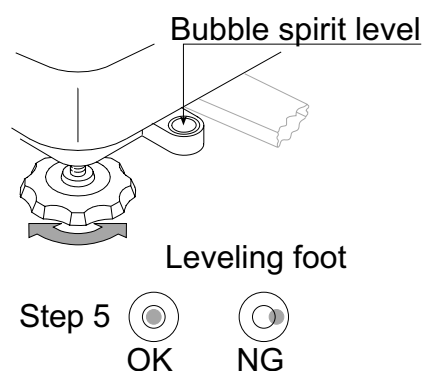

Step 6 Adjust the Display Unit

Press the caps at the pole top from both sides and adjust the angle of the display unit.

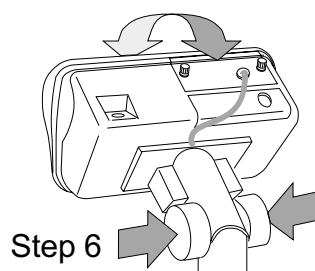

Step 7 Connect the Power

Install the batteries (see page 11) or connect the AC adaptor or mains cable. Check the weighing accuracy. If the scale needs calibration, refer to “14 Calibration”.

